

COLOURBOND NAILSTRIP FIXING INSTRUCTIONS

TYPICAL EAVES GUTTER

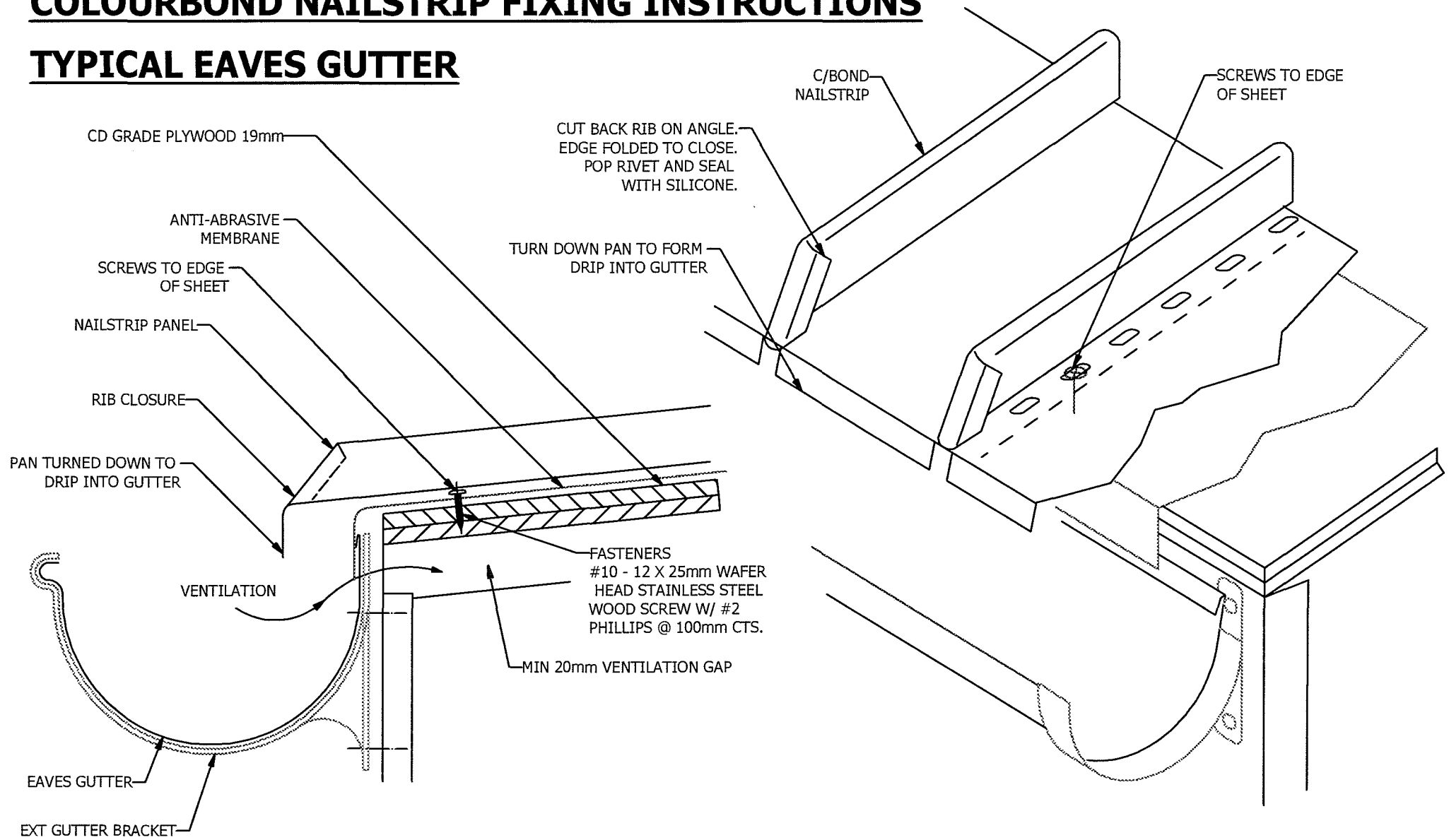

COLOURBOND NAILSTRIP FIXING INSTRUCTIONS

TYPICAL CAPPING WITHOUT GUTTER

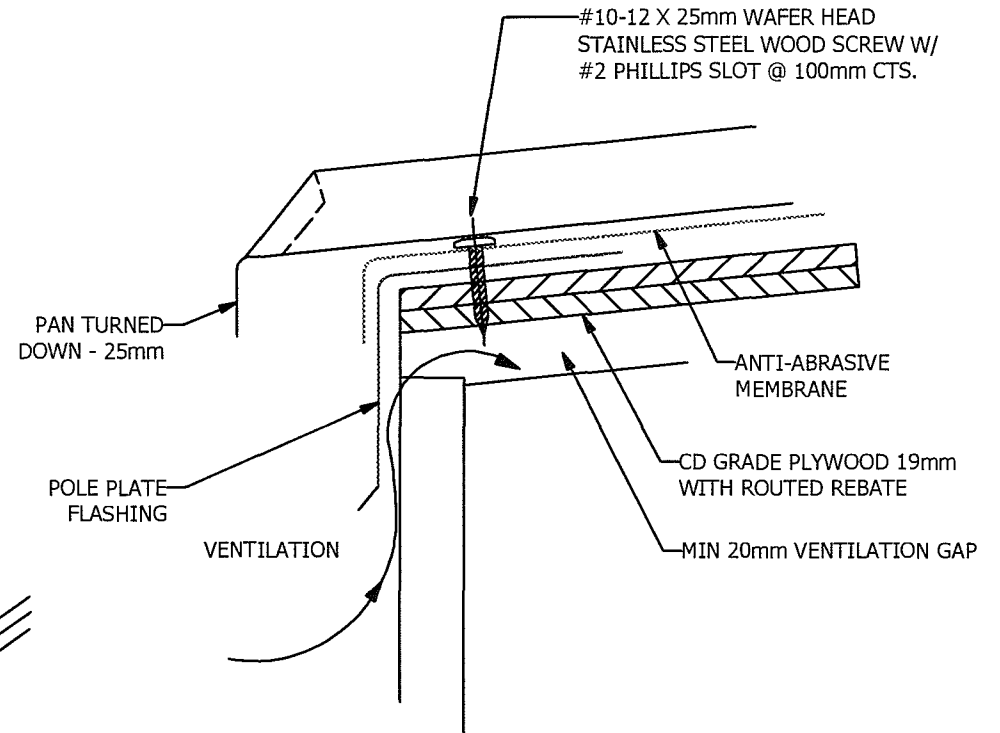
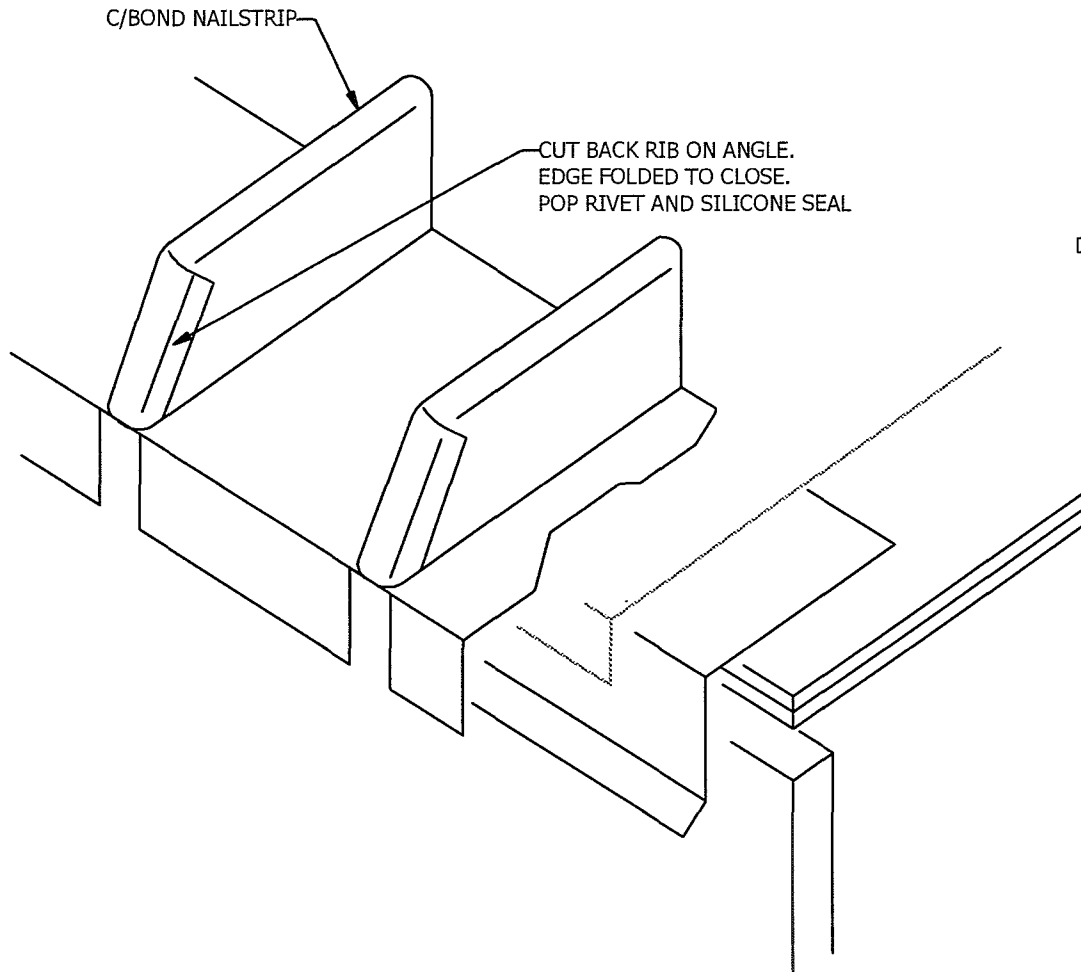

COLOURBOND NAILSTRIP FIXING INSTRUCTIONS

TYPICAL CAPPING TO TOP OF SHEET

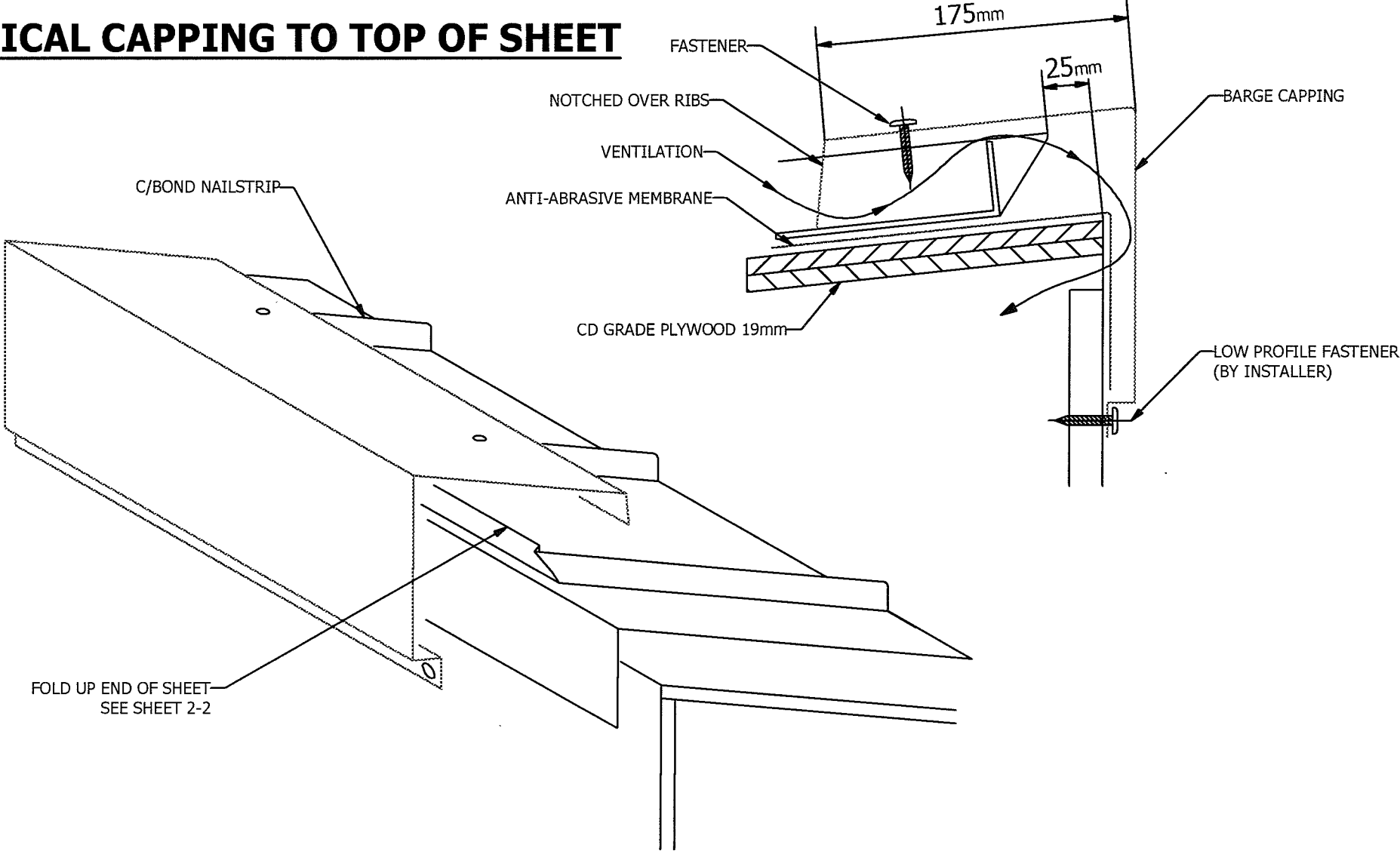

COLOURBOND NAILSTRIP FIXING INSTRUCTIONS

TYPICAL RIDGE

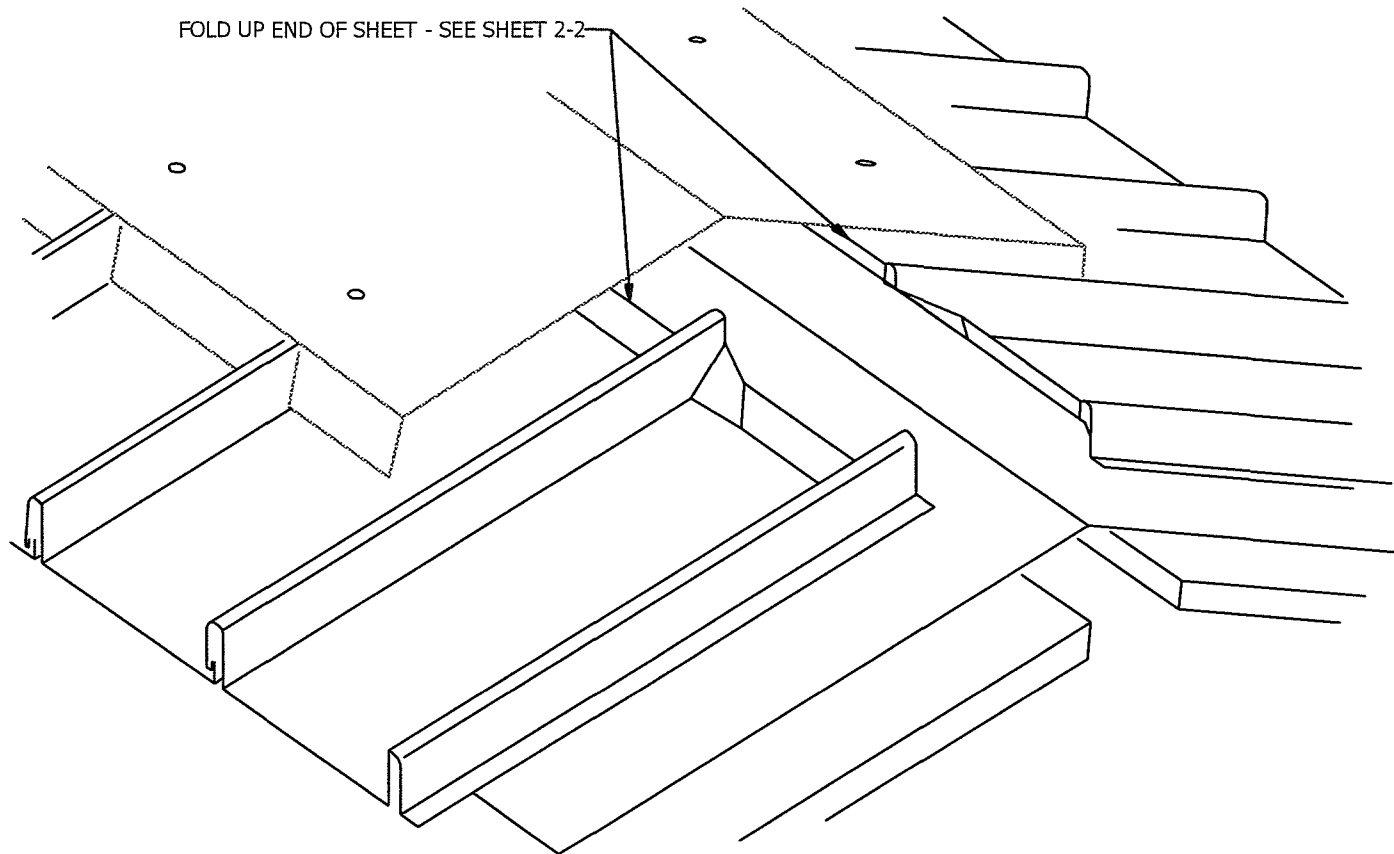
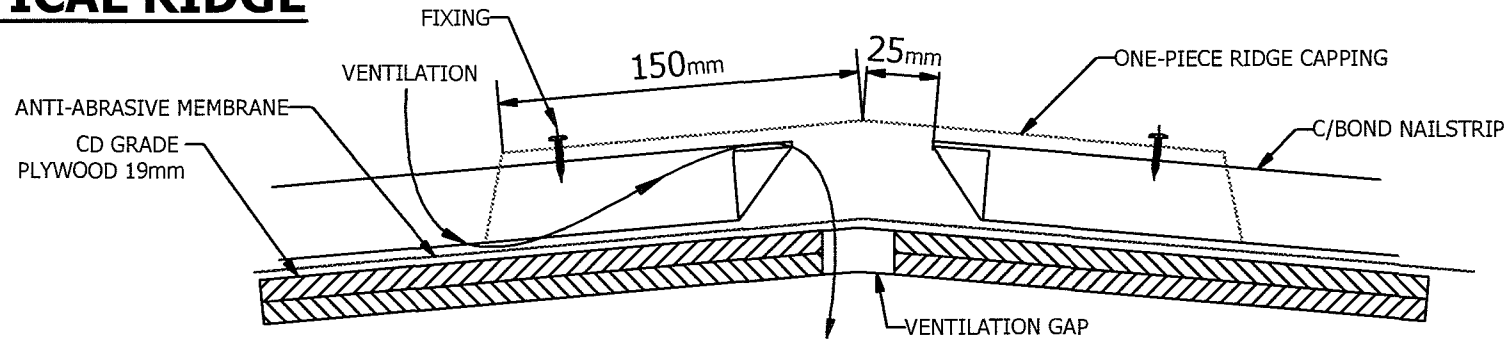

COLOURBOND NAILSTRIP FIXING INSTRUCTIONS

TYPICAL BARGE

OPTION A - 240mm AND UNDER PAN WIDTH

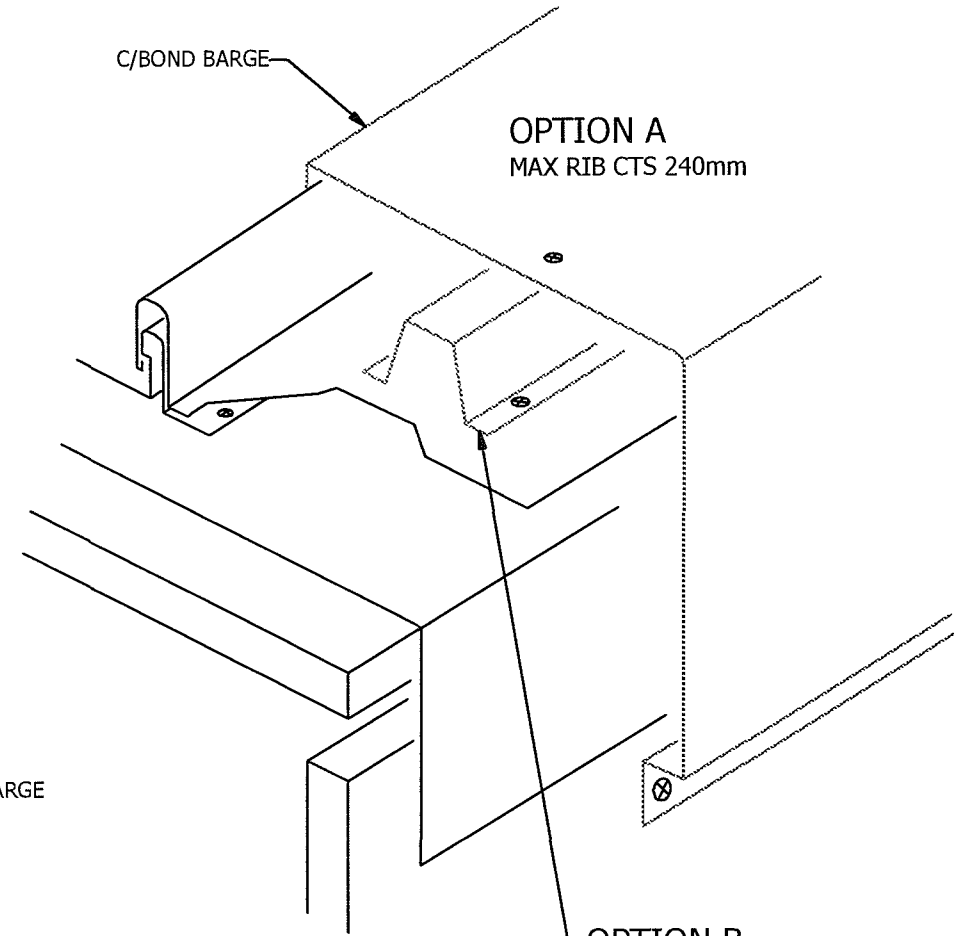
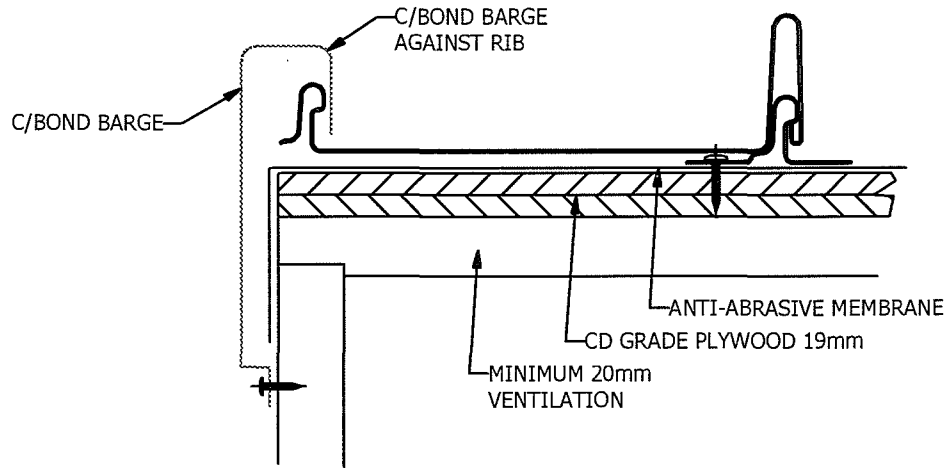

OPTION B - OVER 240mm PAN WIDTH

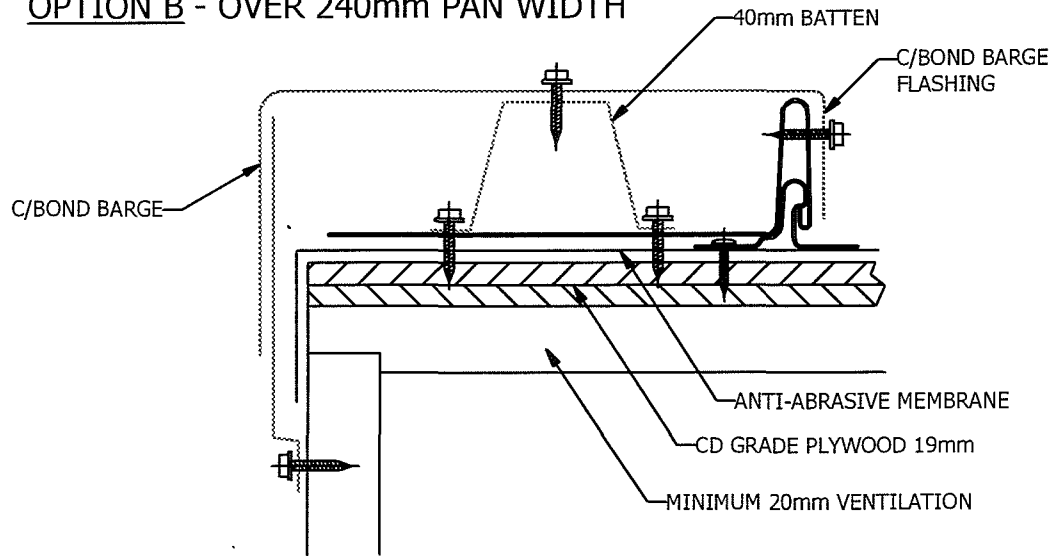

OPTION B
40mm BATTEN
MID SPAN OVER
240 WIDE PAN

COLOURBOND NAILSTRIP FIXING INSTRUCTIONS

TYPICAL APRON FLASHING TO WALL

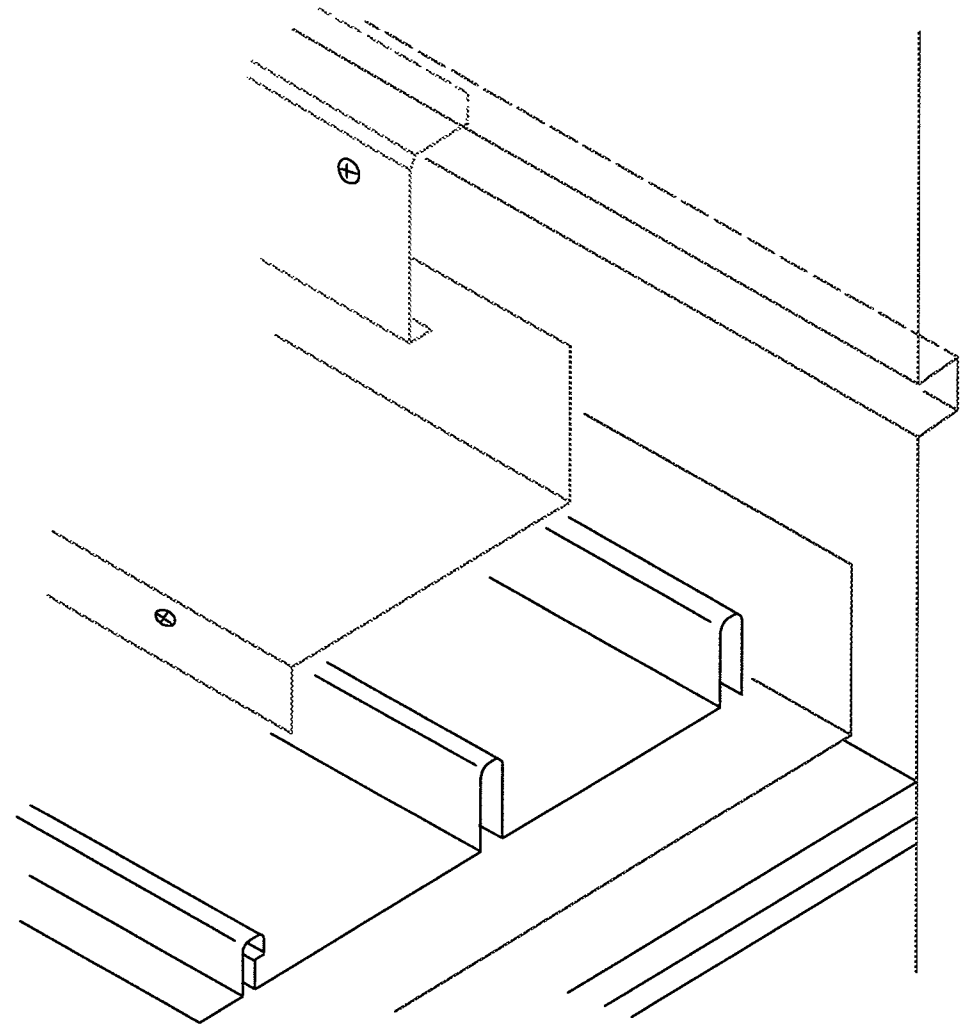
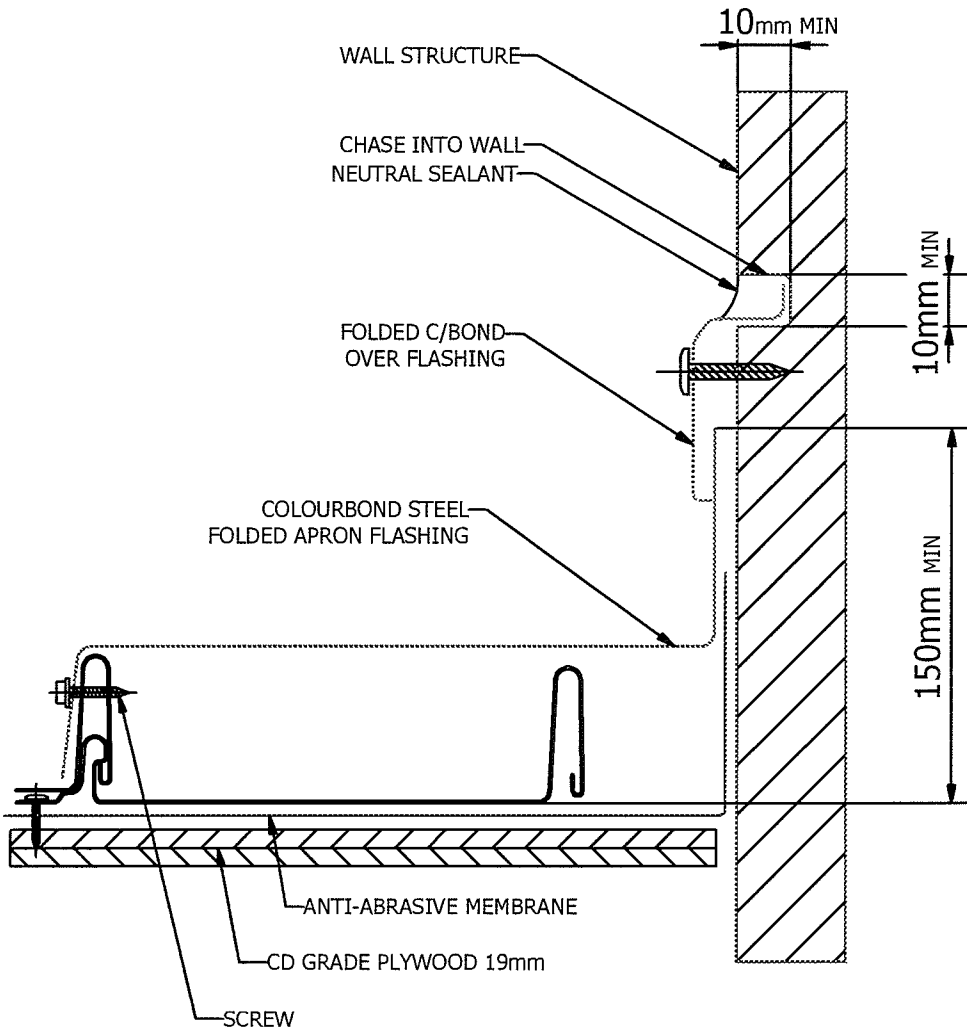

COLOURBOND NAILSTRIP FIXING INSTRUCTIONS

TYPICAL VALLEY OVER 7.5°

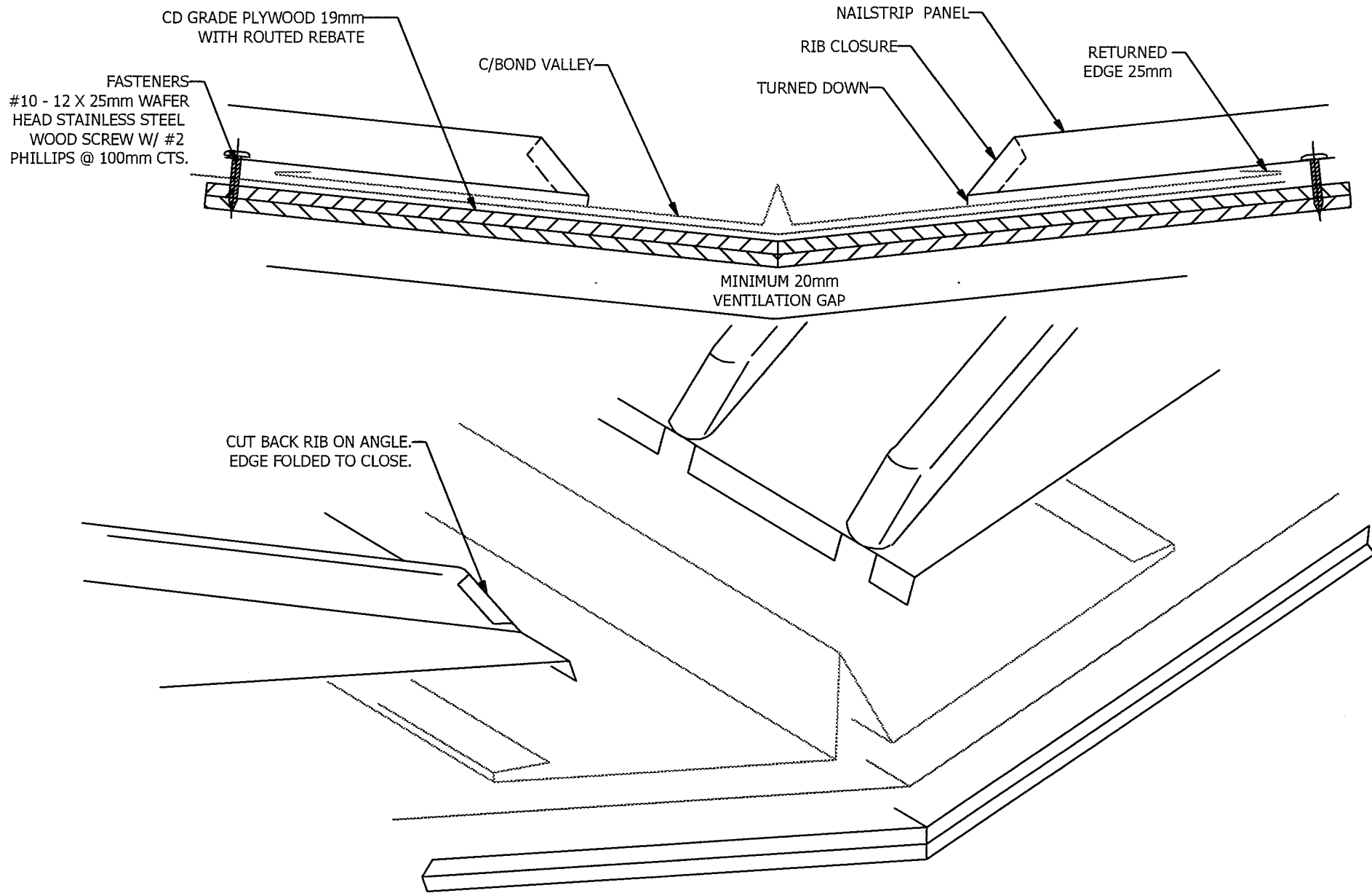

COLOURBOND NAILSTRIP FIXING INSTRUCTIONS

TYPICAL VALLEY UNDER 7.5°

